

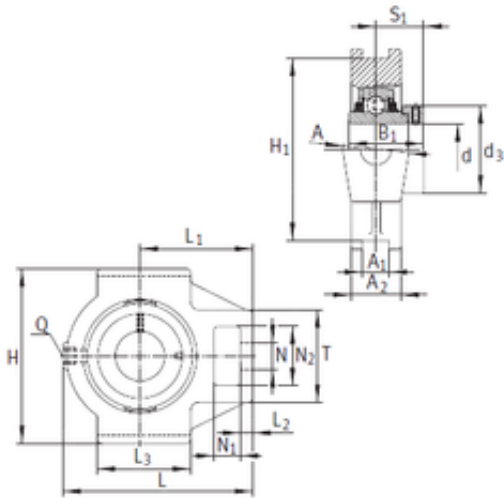

BEARING DRIVESHAFT ANDERSON, INC.



TTUE80 Bearing 2D drawings and 3D CAD models

INA TTUE80 Bearing unit

Bearing No. TTUE80

Bore Diameter	80 mm
d	80 mm
S1	47,6 mm
Thread (Q)	Rp1/8
L2	20 mm
L3	120 mm
d3	108 mm
A	70 mm
A1	28 mm
B1	70,7 mm
H	184 mm
H1	165 mm
L	230 mm
L1	140 mm
N	41 mm
N1	35 mm
T	110 mm
A2	50 mm
N2	70 mm
Weight	7,7 Kg
Basic dynamic load rating (C)	72 kN
Category	Take Up Unit Bearings
Inventory	0.0
Manufacturer Name	SCHAEFFLER GROUP
Minimum Buy Quantity	N/A
Weight / Kilogram	10.131



BEARING DRIVESHAFT ANDERSON, INC.

EAN	4012802817867
Product Group	B04334
Component Description	Take Up Bearing Only
Rolling Element	Ball Bearing
Housing Style	Unit Only
Mounting Method	Eccentric Collar
Compatible Take Up Frame	Not Specified
Adjustment Travel Length	0
Insert Part Number	GE80KPPB3
Housing Material	Cast Iron
Other Features	Single Row Spherical Double Triply Seal
Inch - Metric	Metric
Long Description	Take Up Bearing Only; 80MM Bore; 28MM Slot Width; 165MM Slot to Slot Distance; Ball Bearing; Unit Only; Eccentric Collar Mount; GE80KPPB3 Insert Part; Cast Iron Housing Material
Category	Take Up Units
UNSPSC	31171533
Harmonized Tariff Code	8483.20.40.40
Noun	Bearing
Keyword String	Take Up
Manufacturer URL	http://www.ina.com
Weight / LBS	18.522
Slot Width	1.102 Inch 28 Millimeter
Bore	3.15 Inch 80 Millimeter
Slot to Slot Distance	6.496 Inch 165 Millimeter