

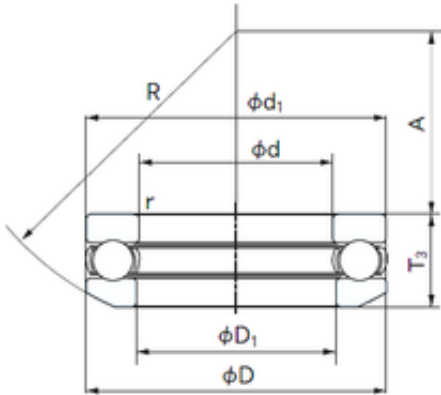

BEARING DRIVESHAFT ANDERSON, INC.

NACHI 53320 Thrust ball bearings

Bearing No. 53320



53320 Bearing 2D drawings and 3D CAD models

Size	100x170x59.2 mm
Bore Diameter	100 mm
Outer Diameter	170 mm
Width	59.2 mm
d	100 mm
D	170 mm
T	59.2 mm
d1	170 mm
r min.	1.5 mm
A	46 mm
D1	103 mm
R	125 mm
Weight	5.12 Kg
Basic dynamic load rating (C)	236 kN
Basic static load rating (C0)	595 kN
(Grease) Lubrication Speed	1000 r/min